

AUDAX GROUP
Envision The World With Technology

LED Panel

About us

Introducing Audax Group, a leading technology solutions provider based in Singapore. Established in 2010, our company is dedicated to delivering cutting-edge solutions to a diverse range of clients. Our team of IT engineers, creative consultants, graphic artists and designers work closely with clients to provide the ultimate viewing experience through advanced media display hardware.

We specialize in architectural, development, museum exhibitions, and government and private sector projects. Our expertise and innovative approach have established us as a trusted provider of premium technology solutions.

We are proud to offer 4 exciting products to enhance your business operations.

- ❖ - Maxhub is a comprehensive conference and education solution that revolutionizes the way people learn and communicate.
- ❖ - AI Robotics is an intelligent delivery robot that delivers food orders or other materials with ease and efficiency to customers.
- ❖ - Ecoprop is a property smart platform that combines both AI and VR for an immersive home viewing experience.
- ❖ - Audax Visuals can provide AR and VR solution for property developers, and exhibition halls designs

Our goal is to create a powerful connection between your product and your audience, helping you achieve your marketing objectives. With realistic visual content and advanced display technology, Audax Group is the one-stop solution for all your technology needs.

Our Solutions



Audax Visuals

3D Services
AR&VR Solution
Immersive Hall Design
Interactive Program

MAXHUB

Conference Solution
Education Solution
Display Solution



BellaBot

Premium Delivery Robot



AI Robotics

Intelligent Delivery Robot
Cleaning Robot
Cooking Robot

EcoProp

Property smart platform
AI+VR Home reviewing



Audax Milestones

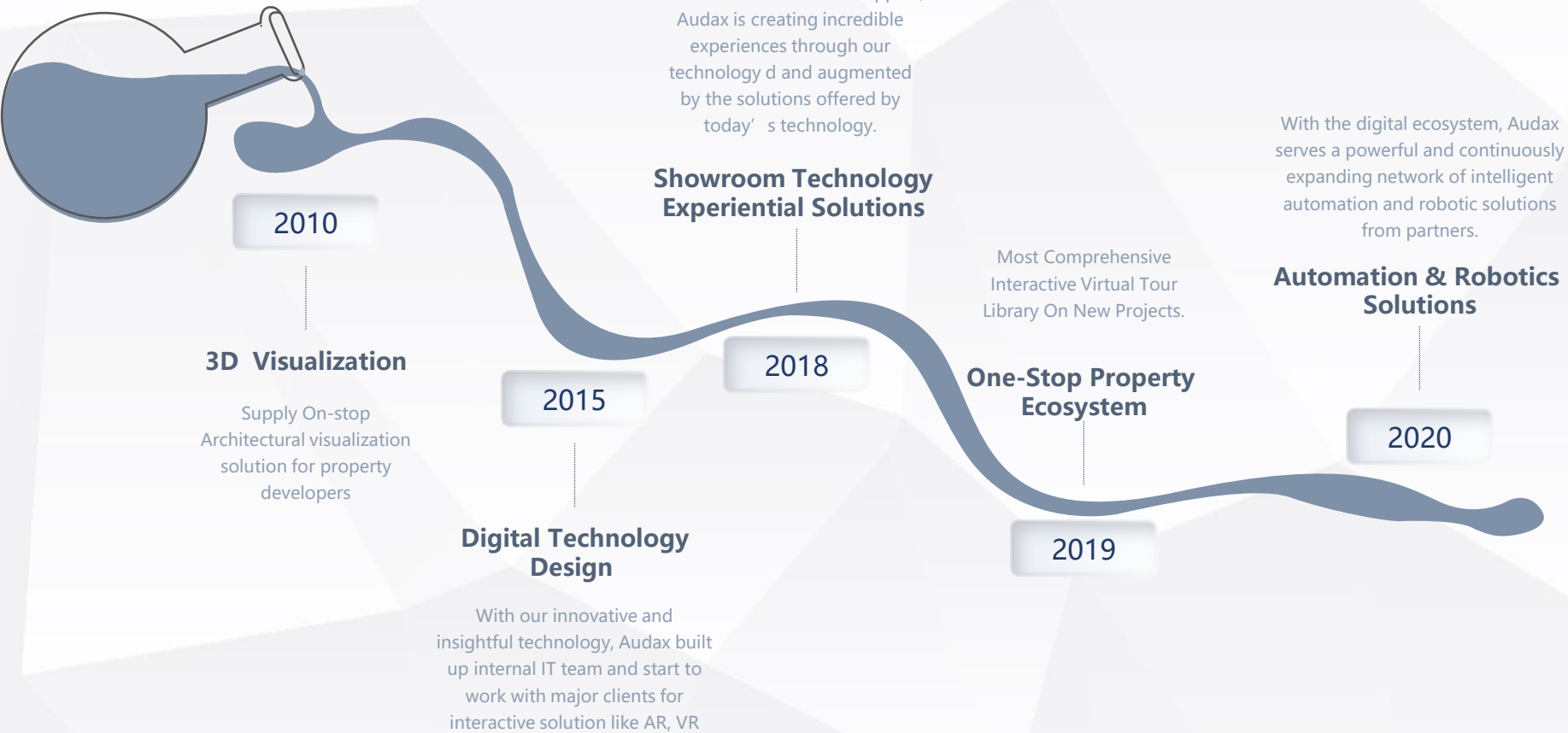

Our Strength

High Quality Product& Customized Solution



Indoor/Outdoor LED Screen



Transparent LED Screen



Projector Screen



Meeting Room All-in-1 panel



3D Naked-Eye Panel & Content



3D Luminous Strips

Our Strength

One-stop service

Solution design

- ✓ Product selection
- ✓ Control system
- ✓ Construction design
- ✓ Installation plan

Project delivery and guidance

- ✓ Installation construction
- ✓ Screen debugging
- ✓ Project acceptance

Post-sale

- ✓ 7*24h online service
- ✓ Local onsite service
- ✓ Original maintenance
- ✓ Spare parts supply
- ✓ Maintenance service

Creative Content

- ✓ Customized display content
- ✓ 3D Naked Eye content available

Product Photos

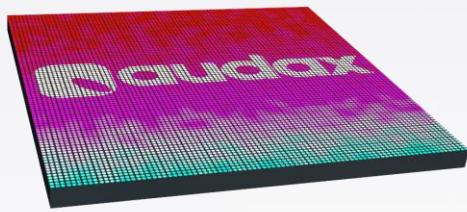



Retail & Commercial



Zegna Singapore, 2024
P1.86 LED Screen



Gucci, 2023
P1.86 Column LED Screen



Tiffany & Co , 2023
P1.86 LED Cube Screen



Tiffany & Co , 2023
P1.86 Curve LED Screen



Tiffany & Co , 2023
P1.86 LED Screen



Swee Lee Flagship, 2024
Multiple LED Screen /Display Screen



Puma , 2024
P1.86 LED Screen

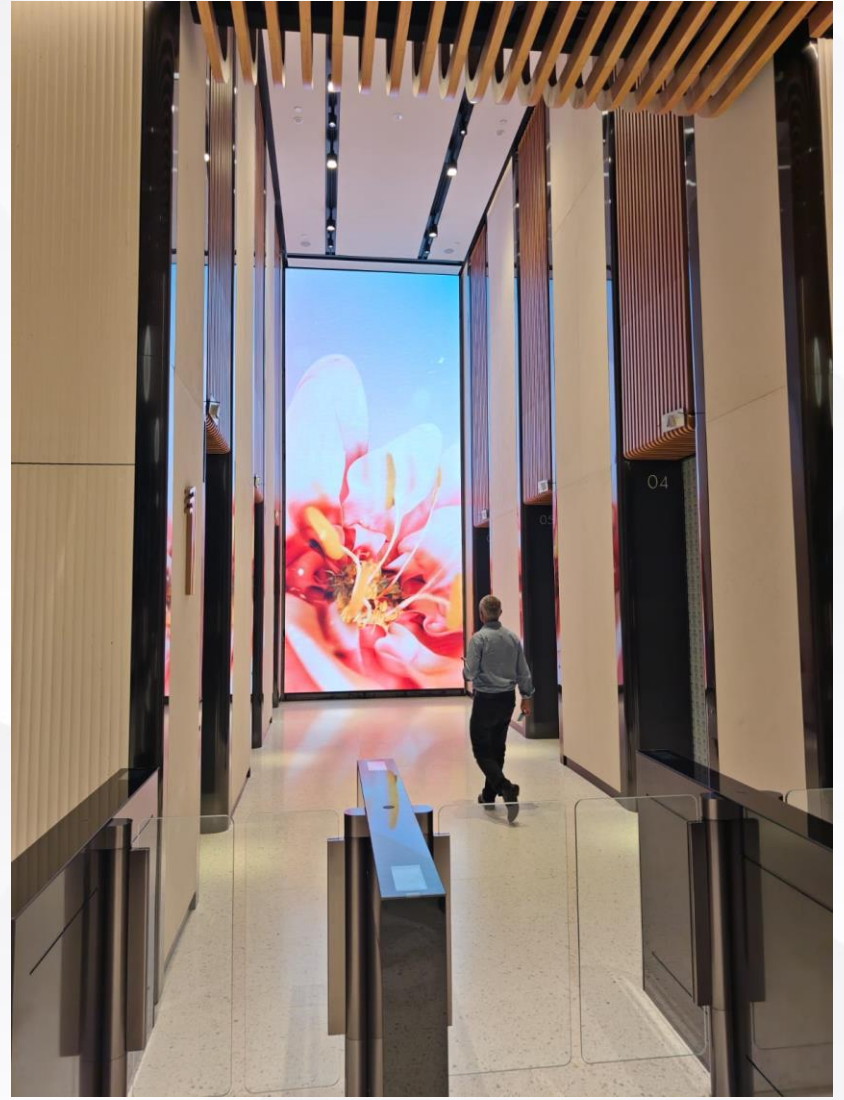

71 Robinson Road , 2023
P2.5 LED Screen Wall



Ngee An City, 2023
P1.8 LED Screen Wall

Office & Cooperate



Coca-cola Headquarter Singapore, 2024
Multiple LED Screens

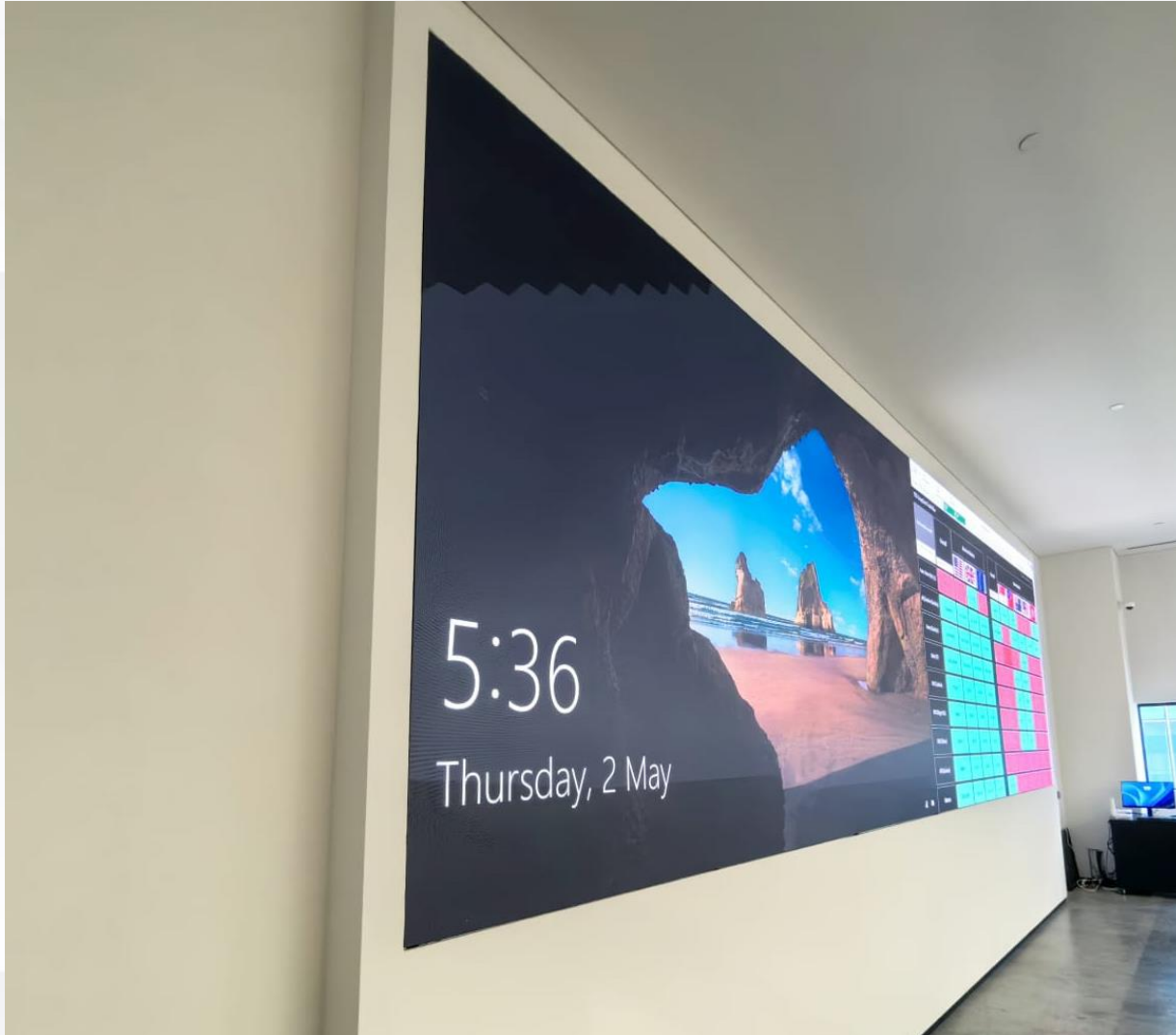

Charles & Keith Command Center, 2023
P2 LED Screen Wall



Biosyngen, 2023
COB P1.5 LED Screen Wall



SACH, 2023
P3 LED Screen Wall



Surbana Jurong, 2023
220 inch LED Screen Wall



65 Equity, 2022
120 inch LED Screen Wall



SR1, 2022
120 inch LED Screen Wall



Gallery & Showroom

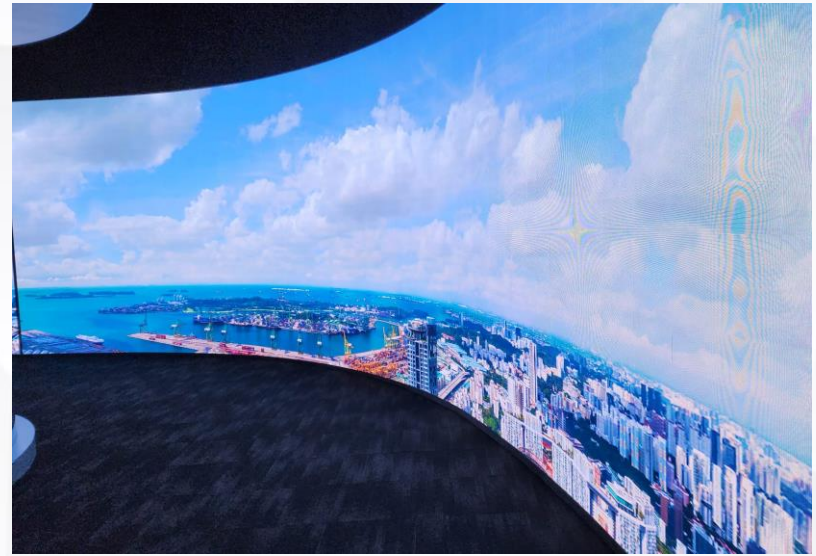

Skywater , 2023
Multiple LED Screens



**The Lake Garden Residences , 2023
Multiple LED Screens**





TMW Maxwell showroom , 2023
Multiple LED Screens



TMW Maxwell showroom , 2023
P3.9 Transparent LED Screen



M.SPACO, 2022
P1.5 Indoor LED (4.8m*2.4m)



Canninghill Piers by City Development Limited, 2021
P3 Indoor Soft Module (6.8m x 3.8)



Canning Piers by City Development Limited, 2021
P2.9 Indoor Hard Module (2m (W) x 3.5 (H))



Canning Piers by City Development Limited, 2021
P2.9 Indoor Hard Module (4m x 2.2m)



**Canning Piers by City Development Limited, 2021
P2.9 Indoor Hard Module (5.5m x 3m))**



Pasir Ris 8 by Allgreen Properties, 2021
P3 Indoor Hard Module (each wall 7m x 4m)



IHG Hotel at East Coast 2020
Curve LED screen P2

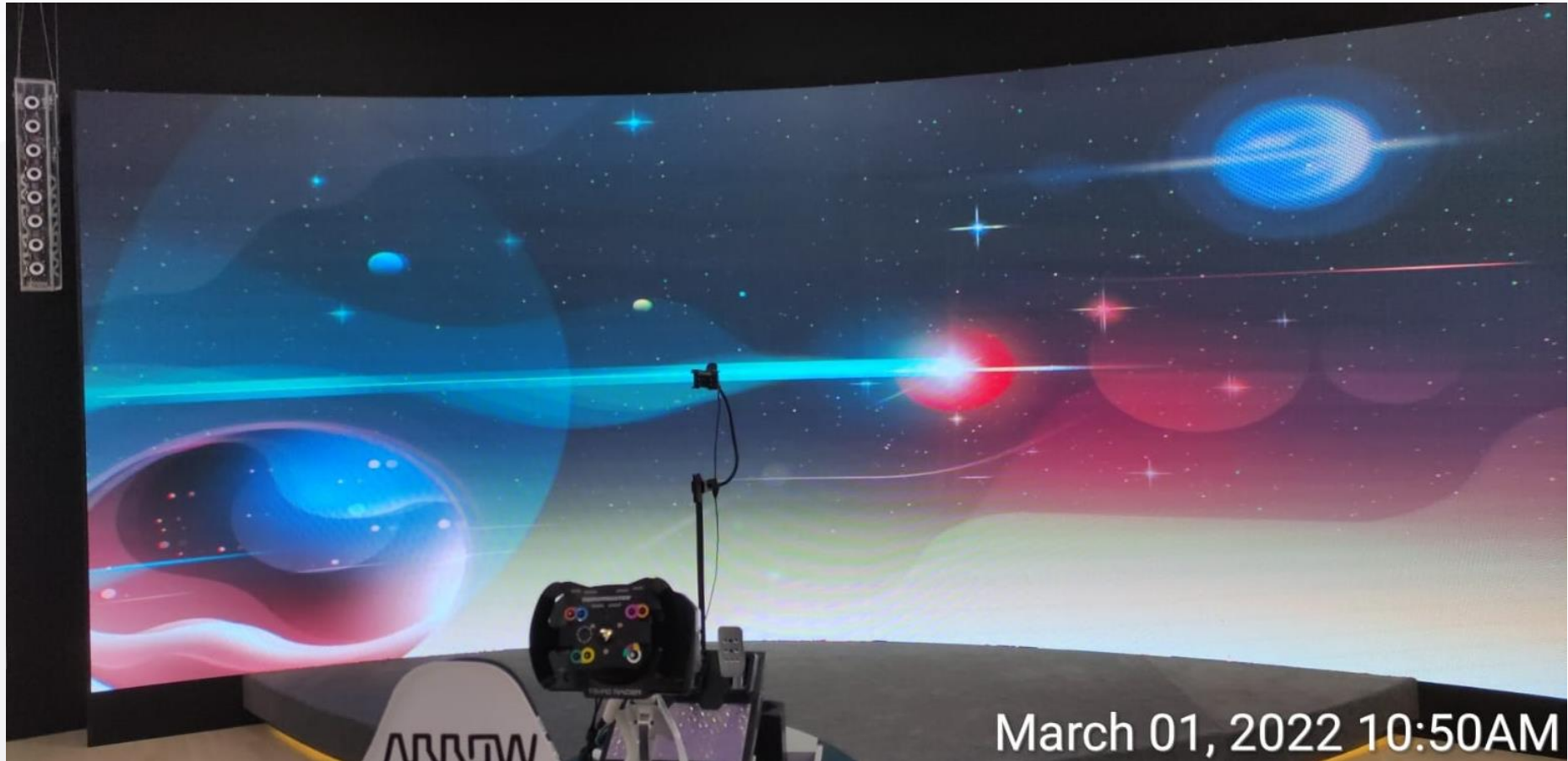

Aerospace, 2022
P3 Indoor Soft Module (5.5m*2.3m)



The Commodore by JBE Holdings, 2021
P2.5 Indoor Hard Module (4.2m x 2.6m)



One Bernam by MCC Land, 2021
P2.5 Indoor Cabinet Hard Module (7m x 3.8m)



Midtown Modern by Guocoland, 2021
P2.5 Indoor Hard Module (4.2m x 2.4m)



KI Residences by Hoi Hup, 2021
P3 Indoor Hard Module (7m x 3m)

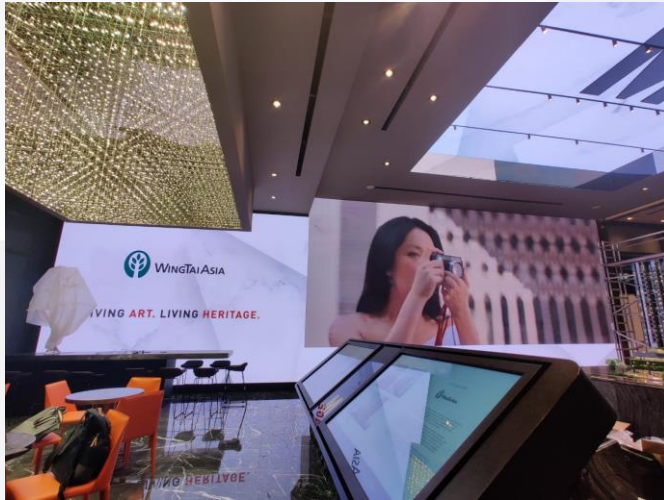

The M Residences by Wing Tai Asia, 2020
Wall - P3 Indoor Hard Module (15m x 5m)
Ceiling – P5 Indoor Hard Module (6m x 5m)



Sengkang Grand Residences by City Development Limited, 2020
P3 Indoor Hard Module (6m x 3m)

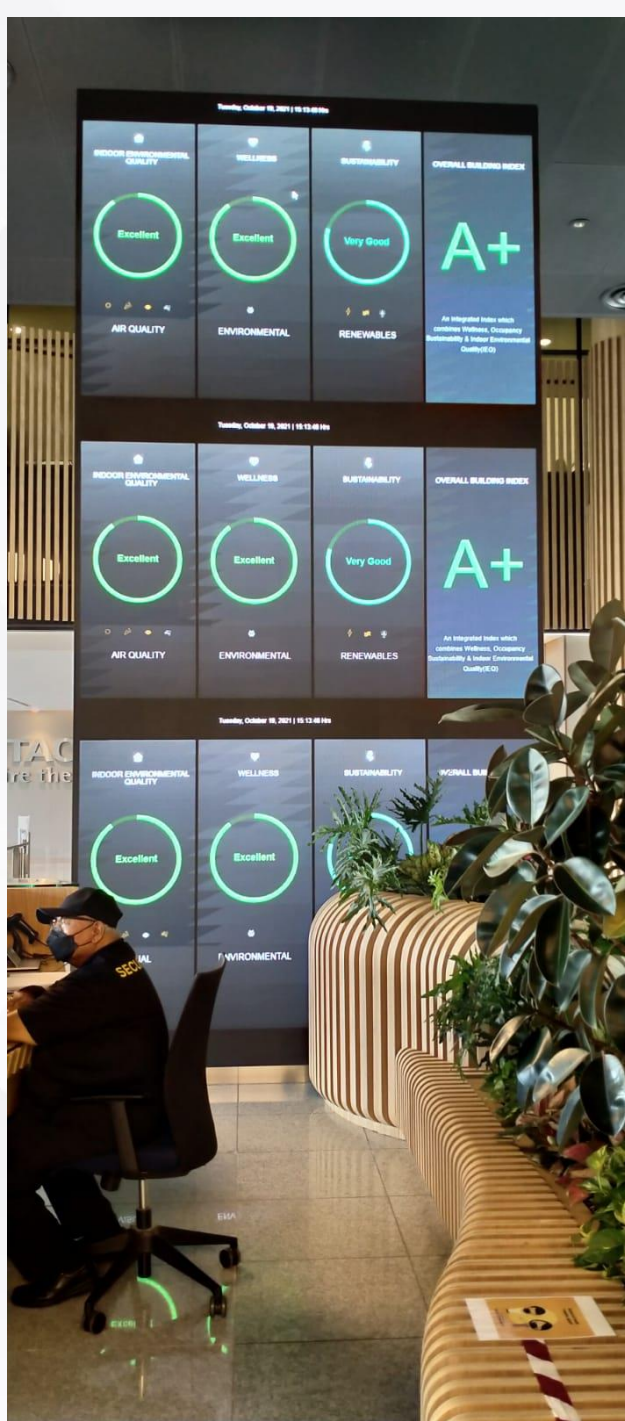
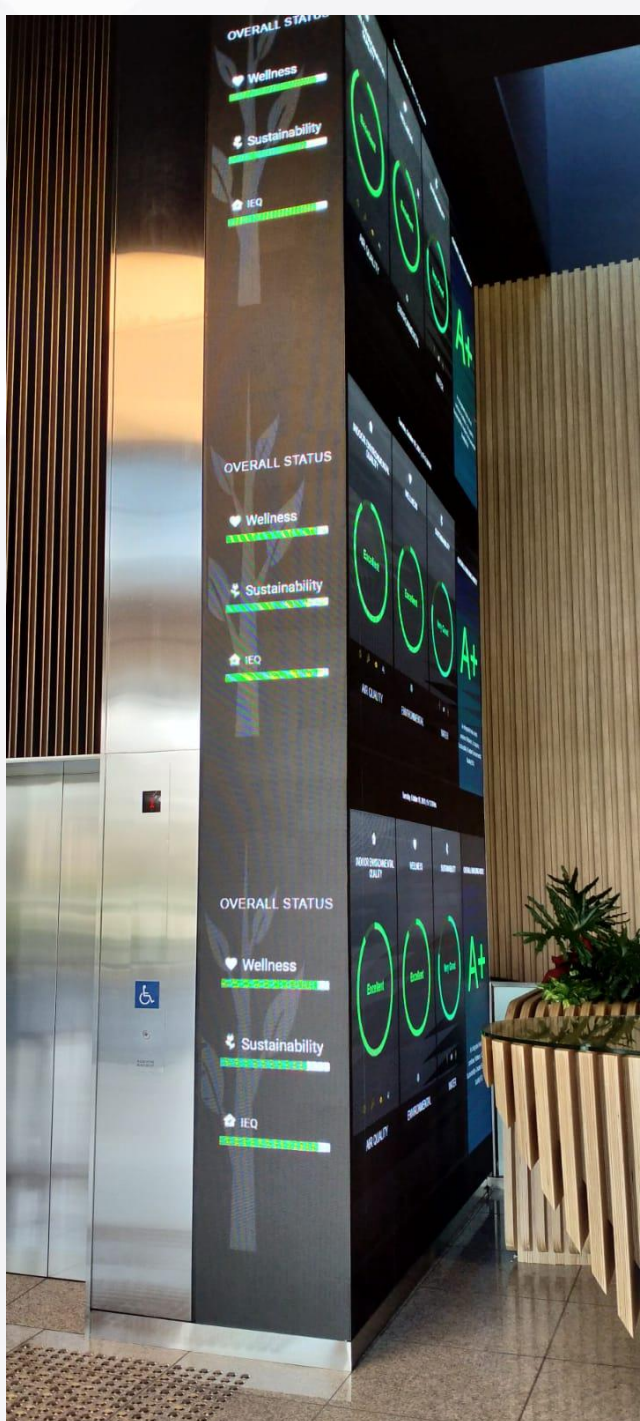

**Hitachi Asia by Evia Holdings
P3 Indoor Hard Module (2.7m (W) x 5.6
(H), 0.6m (W) x 5.6 (H))**



Amber Park by City Development Limited, 2019
P3 Indoor Hard Module (6m x 3m)



Haus on Handy by City Development Limited, 2019
P3 Indoor Hard Module (5.7m x 3m)



DPA Main Office @ Marina Square by DP Architects, 2019
P2.5 Indoor Cabinet Soft Module (3.7m x 2.3m)



Midtown Modern by Guocoland, 2019
P2.5 Indoor Hard Module (3.8m x 2m)



Parc Clematis by Singhaiyi, 2019
P3 Indoor Hard Module (Main wall - 8m x 2.4m, Side wall – 6m x 2.4m)



18 Robinsons by Tuan Sing Holdings, 2019
P2.5 Indoor Hard Module (6m x 3m)



Landmark Tower by ZACD Properties, 2019
P3 Indoor Hard Module (6m x 3m)



Treasure at Tampines by Sim Lian Group, 2019
P3 Indoor Hard Module (5m x 2.8m)



Sky Everton by SL Capital, 2019
P3 Indoor Hard Module (4m x 2.3m)

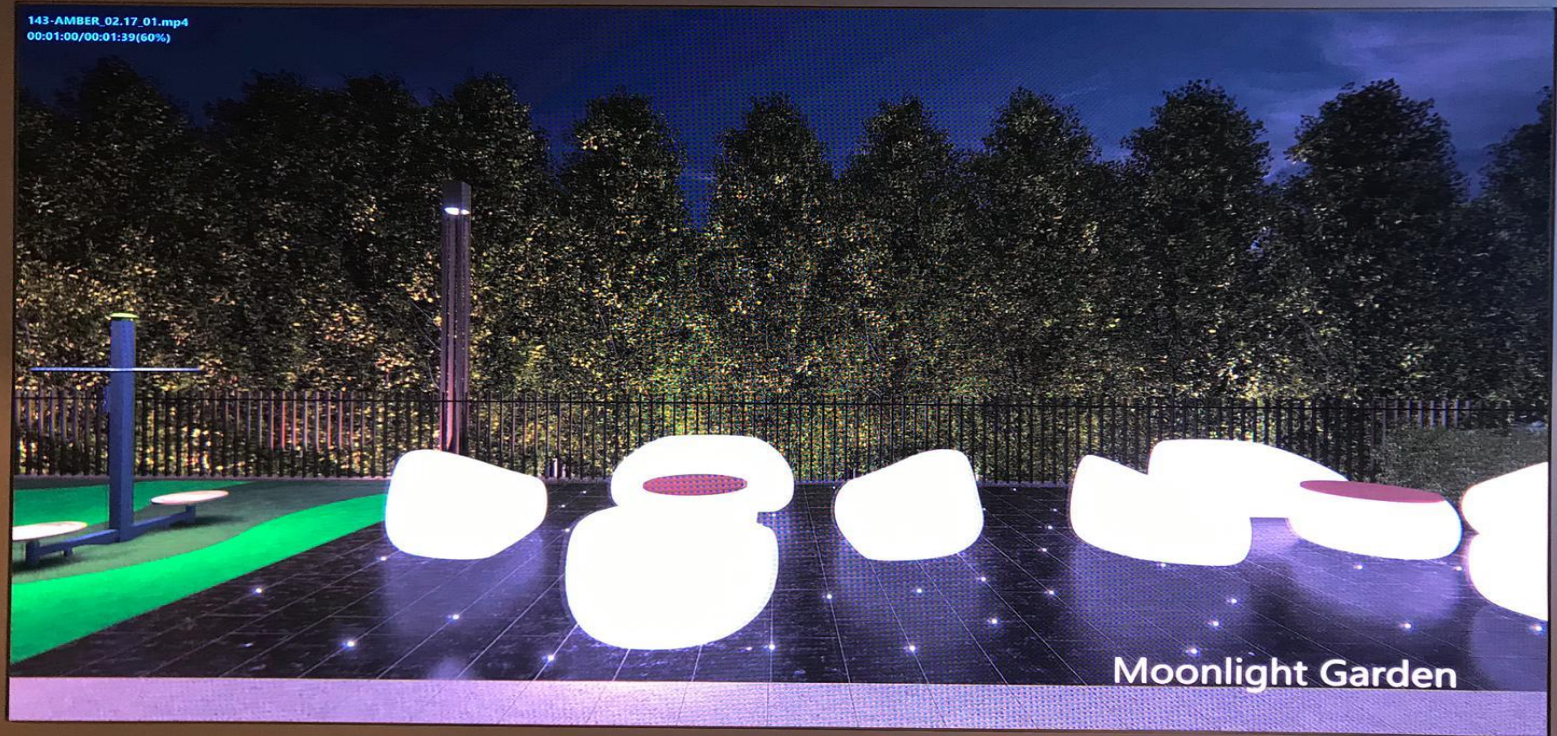

Lilium and Gazania by Singhaiyi, 2019
P3 Indoor Hard Module (4.6m x 2.6m)



Jadescape Residences by Qingjian, 2019
P3 Indoor Hard Module (8m x 4m)

Others projects

| Project | Year | LED | Size |
|---|-------------|---------------------------------|-------------|
| Dairy Farm Residences by United Engineering | 2019 | P3 Indoor Hard Module | 2.5m x 1.6m |
| Leedon Green by MCL | 2019 | P2.5 Indoor Hard Module | 3.5m x 2.5m |
| Jurong Kechil by CSC Land Group | 2019 | P3 Indoor Hard Module | 4.4m x 2.4m |
| Holland Village Residences by Far East Organization | 2019 | P3 Indoor Hard Module | 3.7m x 2m |
| Irwell Residences by City Development Limited | 2020 | P2.9 Indoor Hard Module | 2.8m x 1.5m |
| Parc Central by Hoi Hup | 2020 | P3 Indoor Hard Module | 6.m x 3.4m |
| The Atelier by Bukit Sembawang | 2020 | P2.5 Indoor Hard Module | 8m x 4m |
| Canberra EC | 2021 | P2.5 Indoor Cabinet Hard Module | 5.1m x 2.8m |
| Park Nova by Shuntak Holdings | 2021 | P2 Indoor Hard Module | 2.9m x 1.6m |
| Provence Residence EC by MCC Land | 2021 | P2.5 Indoor Hard Module | 5.1m x 2.9m |
| NIM Collection by Bukit Sembawang | Coming soon | P2.5 Indoor Hard Module | 3.2m x 1.8m |

Thank you for your time!

**Any enquiry please call us @ 67499810 or
email us at sales@audax.com.sg
63 Ubi Avenue 1, #07-02, 63@Ubi, Singapore 408937**